

2011 Fannie Pell Park Improvements



Project Total - \$710,000
\$639,000 Grant (MEDC)
\$71,000 – City Match

- Entrance to City Hall
- Additional downtown parking (25)
- New ADA pedestrian bridge to central mill
- Demolition of obsolete structures
- New kayak livery
- Public restroom facility

Before:



After:











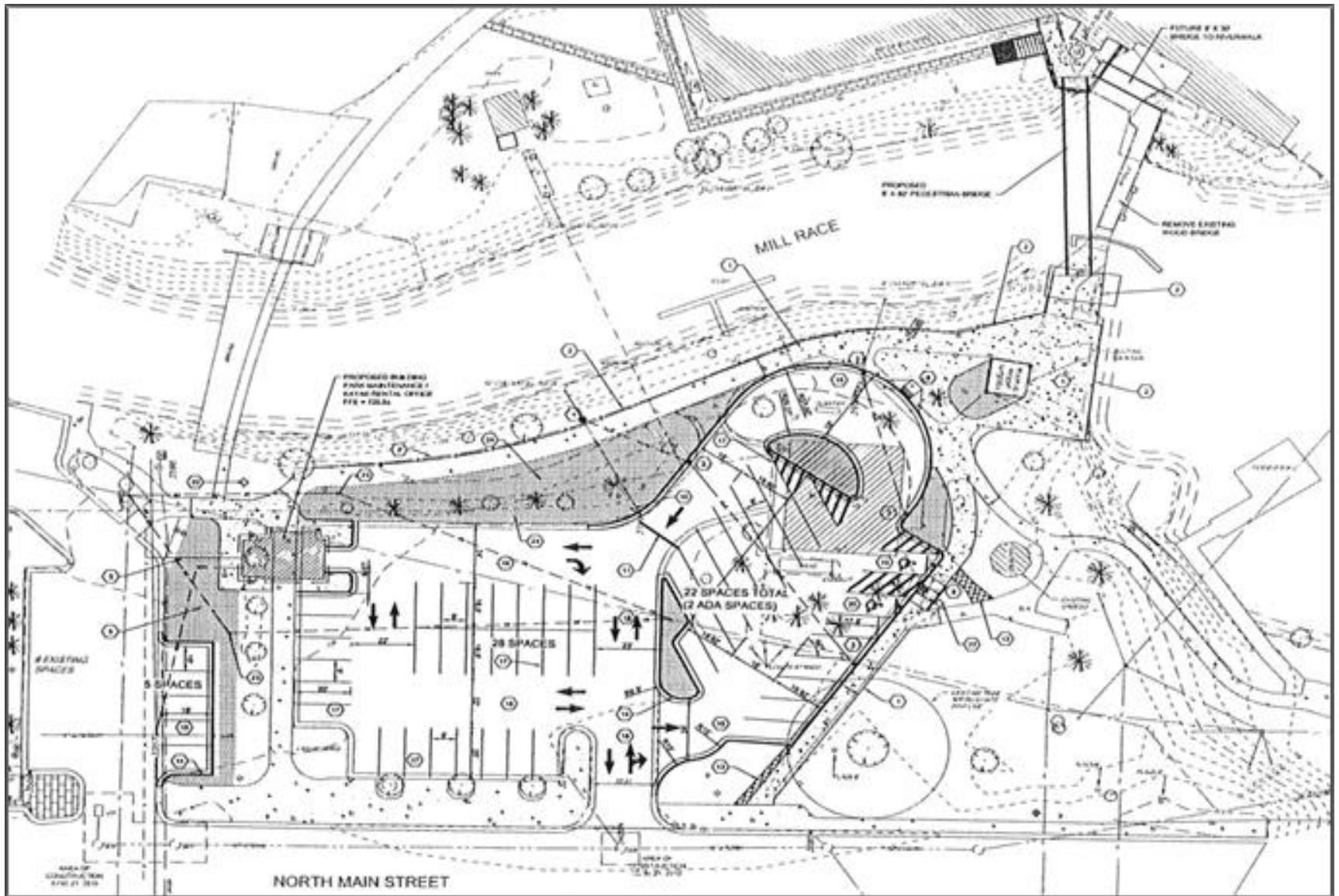



















DANGER
KEEP OUT
SPILLWAY
AHEAD



